

ActivPanel 9

Premium



DISPLAY

Screen Size and Resolution	65" 4K
	75" 4K
	86" 4K
Screen Type	TFT LCD (Direct LED Backlight)
Blue Light Reduction	Yes
Bonded Glass	Yes
Aspect Ratio	16:9
Display Area	65" 4K: 1429 x 804 mm (56.3 x 31.7 in)
	75" 4K: 1652 x 930 mm (65 x 36.6 in)
	86" 4K: 1895 x 1066 mm (74.6 x 41.9 in)
LCD Viewing Angle	178°
LCD Response Time	8 ms
LCD Refresh Rate (Panel)	60 Hz
LED Lifespan	50,000 hours
Contrast Ratio	5000:1 Dynamic 1200:1 Static
Brightness	400 cd/m2
Ambient Light Sensor	Yes
Glass Hardness	9H (pencil), 7 (Mohs)
Glass Type	Heat tempered, Anti-Glare

INTERACTIVITY

Vellum Touch Technology	Yes
Continuous Touch Points	20
Touch Resolution	32768 x 32768 px
Response Time	≤5 ms
Touch Accuracy	1 mm
Tracking Rate	4 m/s
Scan Rate	200 Hz
Gestures and Edge Swipes	Windows® supported
Eraser Included (Block Eraser)	Yes
Unique Pen IDs	2
Pen and Touch Differentiation	Yes
Palm Erase	Yes
Palm Rejection	Yes, writing and non-writing hand
Pens Included	Yes, 4
Pen Type	Battery-less pen
Pen Holder	Integrated full-length pen tray
Pen Tip Diameter	3 mm (Eraser 7 mm)
Classroom Essential Apps	Including Whiteboard, Annotate, Timer, Spinner, Screen Capture, Screen Share, Browser, PDF Reader, Media Player
Compatibility	Windows® 7 to 11; Mac OS® 10.8 to 10.11; macOS® Sierra 10.12.1 or later; Linux® Ubuntu 20.04 LTS; Chrome OS™

COMPUTING

Operating System	ActivPanel OS
RAM	6.5 GB
Internal Storage	64 GB
CPU	ARM CORTEX - A73 x 4
GPU	ARM Mali-G52 2EE MC2
ActivSync™	Yes
Trusted Platform Module	Yes
Cloud Based User Profiles	Yes

AUDIO

Dual Front-facing Speakers	2 x 18 W
Subwoofer	1 x 15 W
Microphone Array	Yes

CONNECTIVITY

OPS Slot	1
HDMI In (Rear)	2 (1 x 2.0, 1 x 2.1)
HDMI In (Front)	1 (2.0)
Display Port	1 (1.2)
USB-A 2.0 (Rear)	1
USB-C 3.2 (Rear)	1 (100 W Power Delivery)
USB-B 3.0 (Touch, Front)	1
USB-B 3.0 (Touch, Rear)	3
USB-A 3.0 (Front)	2
USB-A 3.0 (Rear)	2
MicroSD Slot	Yes
LAN In (RJ45)	1 Gbps
LAN Out (RJ45)	1 Gbps
Wake-on-LAN	Yes
Wi-Fi (Client)	IEEE 802.11 a/b/g/n/ac/ax, Wi-Fi 6 and dual band supported
Bluetooth	5.0
HDMI Out	1 (2.0)
VGA In	1
PC Audio (3.5 mm)	1
AV-In (3.5 mm)	1
Mic (3.5 mm)	1
Audio Out (3.5 mm)	1
RS-232	1
Proximity Sensor for Warm Boot	Yes
NFC (Near-field Communication)	Yes

ActivPanel 9

Premium

PANEL MANAGEMENT

OTA Updates	Yes
Promethean Panel Management	Yes

POWER

Power Requirements	100 V - 240 V AC
Energy Star Power Consumption	65" 4K: 119 W 75" 4K: 163 W 86" 4K: 194 W
Power Consumption (Standby)	<= 0.5 W
Ultra-Quiet Fanless Design	Yes

ENVIRONMENTAL

Operating Temperature	0 °C to 40 °C (32 °F to 104 °F)
Storage Temperature	-15 °C to 55 °C (-5 °F to 131 °F)
Operating Humidity	20% to 80% non-condensing humidity
Storage Humidity	20% to 90% non-condensing humidity

COMPLIANCE & CERTIFICATION

Regulatory Certifications	CE, FCC, IC, UL, CUL, CB, RCM
Energy Star Certified	65" 4K: Yes 75" 4K: Yes 86" 4K: Yes

PHYSICAL SPECIFICATIONS

Panel Dimensions	65": 1508 x 945 x 85 mm (59.4 x 37.2 x 3.3 in) 75": 1730 x 1070 x 86 mm (68.1 x 42.1 x 3.4 in) 86": 1974 x 1207 x 86 mm (77.7 x 47.5 x 3.4 in)
Packed Dimensions	65": 1642 x 1072 x 246 mm (64.6 x 42.2 x 9.7 in) 75": 1860 x 1137 x 246 mm (74.6 x 45.7 x 9.7 in) 86": 2102 x 1300 x 246 mm (84.8 x 52.8 x 9.7 in)
Panel Net Weight	65": 44.5 kg (98.1 lb) 75": 57.8 kg (127.4 lb) 86": 73.3 kg (161.6 lb)
Packed Weight	65": 61.5 kg (135.6 lb) 75": 78.5 kg (173.1 lb) 86": 95.7 kg (211 lb)
Wall Mount Dimensions	1010 x 720 x 52 mm (39.8 x 28.3 x 2.0 in)
VESA Mount Point	65": 600 x 400 mm (23.6 x 15.7 in) 75": 800 x 400 mm (31.5 x 15.7 in) 86": 800 x 600 mm (31.5 x 23.6 in)

EDUCATION SOFTWARE LICENSE

ActivInspire® Professional	Included
Single User	

PACKED CONTENTS

What's in the Box	1x ActivPanel 9 Premium 1x 3 m Length HDMI Cable 1x 3 m Length USB Cable (A-B) 1x 3 m Regional Power Cable 1x 2 m Length USB-C Cable 1x Remote Control 2x Batteries for Remote 4x Pens 1x Block Eraser 1x Sealed Antistatic Bag 8x Desiccant 4x VESA Mount Screws (M6) 1x Mini PC Bracket with Screws (x2) 2x NFC Cards 1x Quick Install Guide 1x Promethean Wi-Fi/Bluetooth Module 3x Antennae 1x Wi-Fi/Bluetooth Module User Guide 1x Wall Mount
-------------------	--

INSTALLATION

The installation of this product should be completed by a qualified installer. Use of components not supplied by Promethean or not meeting minimum specifications may impact performance, safety and warranty. For more information, visit Support.PrometheanWorld.com.

WARRANTY

Warranty term and upgrade options vary by region. Contact your local reseller or distributor for information and visit PrometheanWorld.com/Warranty.

SUPPORT

For all Promethean products, visit Support.PrometheanWorld.com.

ActivPanel 9

Premium

TECHNICAL DRAWINGS

65"

Front

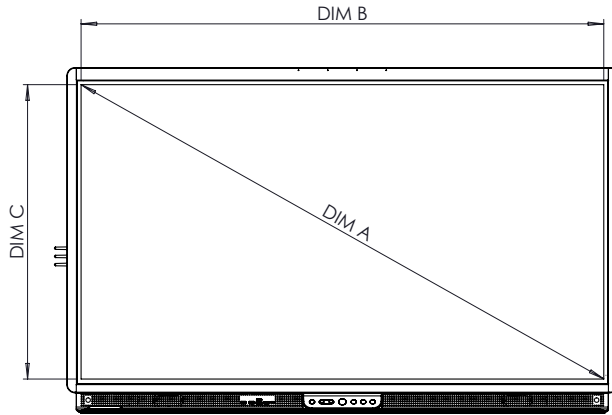

DIM	DIMENSIONS (MM)	DIMENSIONS (IN)
A	1642	64.6
B	1431	56.3
C	806	31.7
E	128	5.0
F	85	3.4
G	945	37.2
H	1508	59.4
I	600	23.6
J	400	15.7

Back

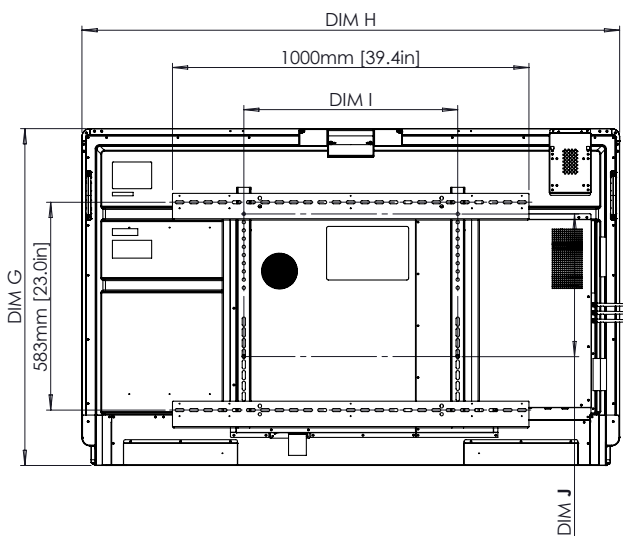

Side

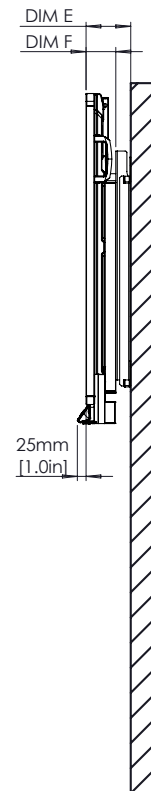

ActivPanel 9

Premium

TECHNICAL DRAWINGS

75"

Front

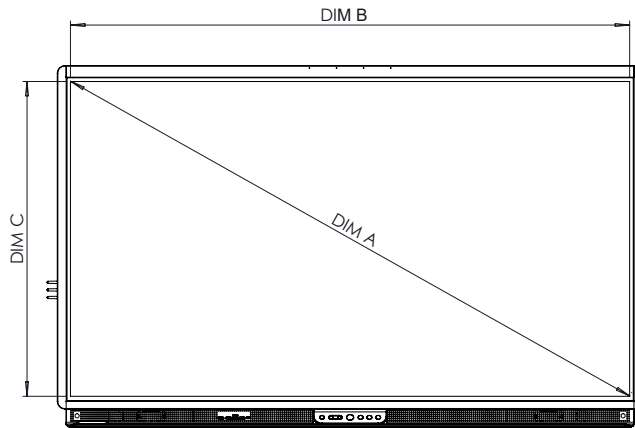

DIM	DIMENSIONS (MM)	DIMENSIONS (IN)
A	1896	74.7
B	1652	65.0
C	930	36.6
E	128	5.0
F	86	3.4
G	1070	42.1
H	1730	68.1
I	800	31.5
J	400	15.7

Back

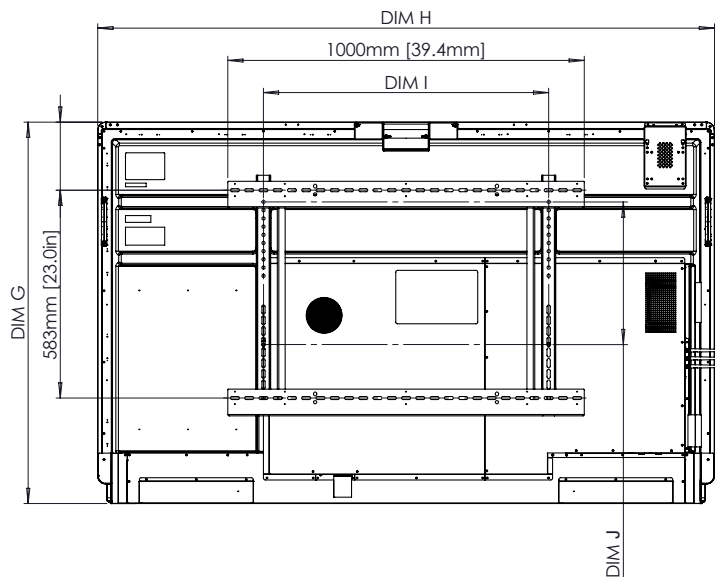

Side

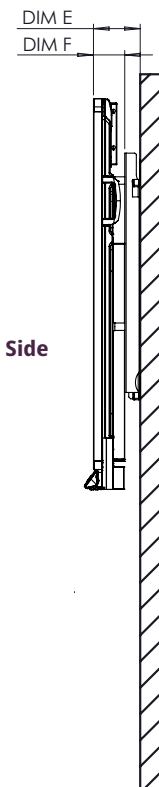

ActivPanel 9

Premium

TECHNICAL DRAWINGS

86"

Front

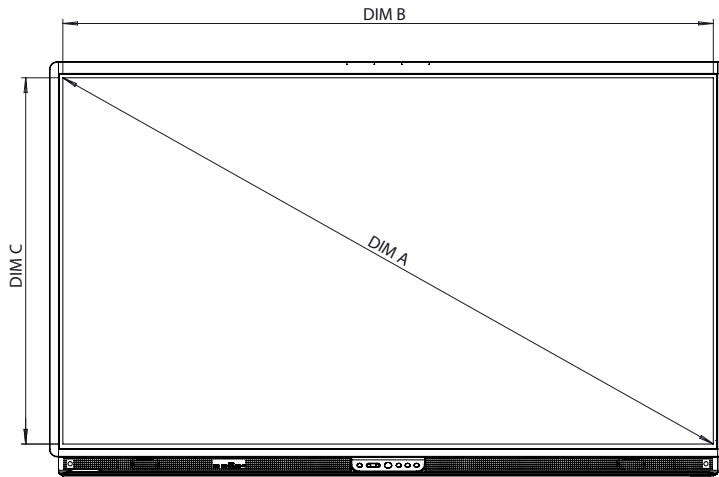

DIM	DIMENSIONS (MM)	DIMENSIONS (IN)
A	2177	85.7
B	1897	74.7
C	1068	42.0
E	128	5.0
F	86	3.4
G	1207	47.5
H	1974	77.7
I	800	31.5
J	600	23.6

Back

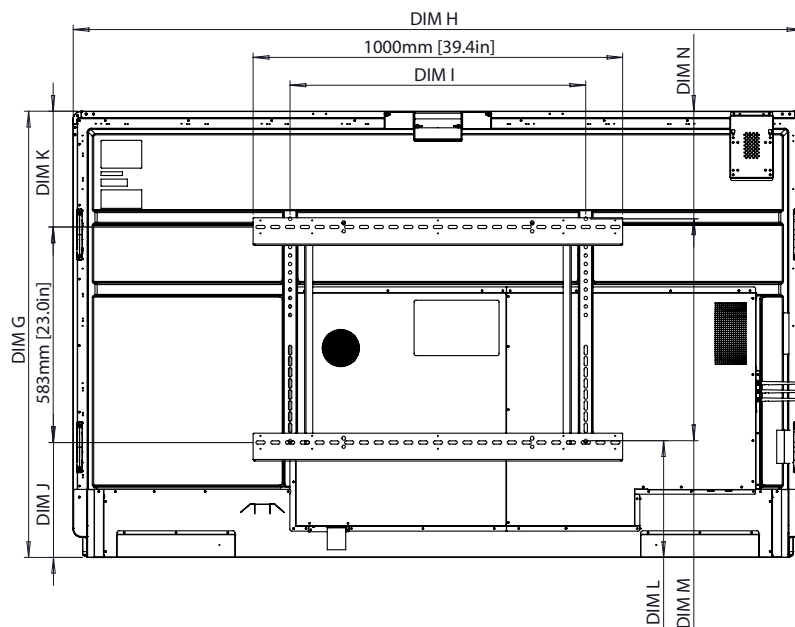

Side

